



**Techni**  
ENGINEERING SOLUTIONS

**MERCEDES SPRINTER**  
**3.0L EURO 5 / 6 / EEV**  
**2500 / 3500 / 219 / 319 / 419 / 519**

---

**CODE / CODICE: 0500.6952**

**COMPRESSOR / COMPRESSEUR /  
KOMPRESSOR / COMPRESSORE / COMPRESOR :**

**SELTEC: TM13 / 15 / 16**  
**QUE: QP13 / 15 / 16**  
**DELPHI SP15**

---

## **FITTING INSTRUCTIONS**

**EINBAUANLEITUNGEN**  
**INSTRUCTIONS POUR LE MONTAGE**  
**ISTRUZIONI DI MONTAGGIO**  
**INSTRUCCIONES DE MONTAJE**

---



**Contents**

<b>ENGLISH</b> .....	4
Parts View.....	4
Parts List .....	5
Compressor Configurations .....	6
Standard Fastener Torque Values .....	6
Kit Details .....	7
Vehicle Details .....	7
Forward .....	7
Pre Installation.....	8
Installation.....	8
Mount Bracket Installation .....	8
Drive Belt Installation.....	9
Finish .....	10

PARTS VIEW / VUE ÉCLATÉE / TEILEANSICHT / VISTA PARTA / IMÁGENES DE LAS PIEZAS

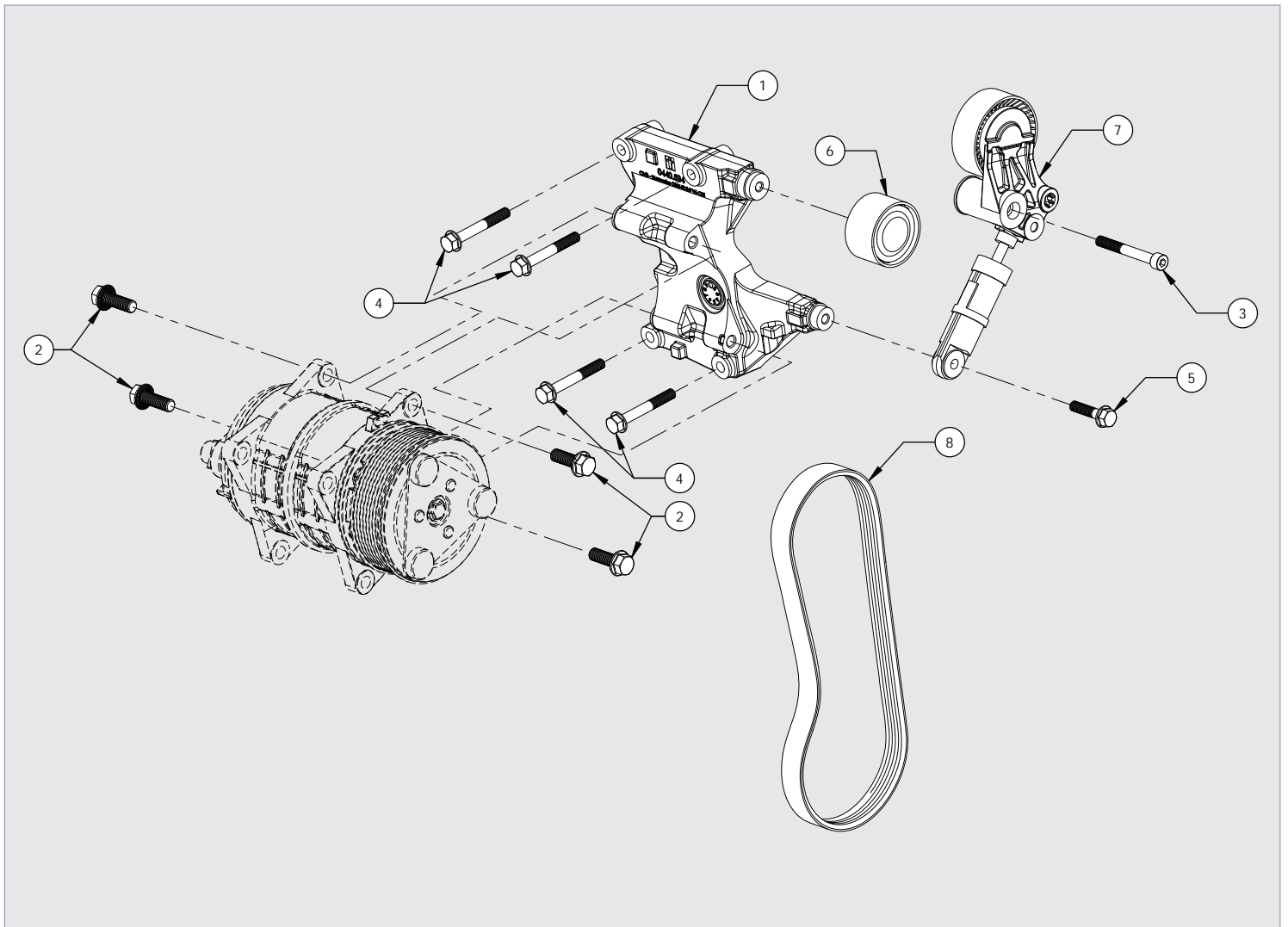

## PARTS LIST / NOMENCLATURE / TEILELISTE / ELENCO DELLE PARTI / LISTA DE PIEZAS

ITEM	CODE / CODICE / KODE / CODIGO	DESCRIPTION / DESCRIZIONE / BESCHREIBUNG / DESCRIPCION	QTY.	COMMENTS
1	0441.5341	Mount Bracket Assembly	1	-
2	2705.0491	Hex flange bolt Durlok - M10 x 30 : 1.50 - 12.9	4	-
3	2704.0601	Socket Head Cap Screw - M8 x 65 : 1.25 - 10.9	1	-
4	2704.1011	Hex flange bolt - M8 x 60 : 1.25 - 10.9	4	-
5	2704.1021	Hex flange bolt - M8 x 35 : 1.25 - 10.9	1	-
6	1700.5161	Idle Pulley 54mm	1	-
7	1705.5061	Automatic Tensioner Assembly	1	-
8	0820.7271	Belt - Poly Groove 6PK 1438	1	-

**COMPATIBLE COMPRESSORS / COMPRESSEURS RECOMMANDÉS / EMPFOHLENE KOMPRESSOREN  
RACCOMANDATO COMPRESSORI / RECOMENDADAS COMPRESORES**

SELTEC	TM-13 HS	TM15-HS	TM16-HS
Comp No	0381.0202	0381.0002	0381.0312
Valeo No.	488-45120	488-55120	488-46134
Mounting	Ear	Ear	Ear
Rotor	8PV	8PV	8PV
GL	46.55mm	46.55mm	46.55mm
Armature	3E	3E	3E
Diameter	123	123	123
Voltage	12	12	12
Orientation	V	V	V
Fitting	3/4 x 7/8	3/4 x 7/8	3/4 x 7/8
Manifold	Bolt	Bolt	Bolt

QUE	QP13-HD	QP15-HD	QP16-HD
Comp No	0391.0202	0391.0002	0391.0312
Que No.	QP13-1302	QP15-1171	QP16-1195
Mounting	Ear	Ear	Ear
Rotor	8PV	8PV	8PV
GL	46.55mm	46.55mm	46.55mm
Armature	3E	3E	3E
Diameter	123	123	123
Voltage	12	12	12
Orientation	V	V	V
Fitting	3/4 x 7/8	3/4 x 7/8	3/4 x 7/8
Manifold	Bolt	Bolt	Bolt

SANDEN	-	-	-
Comp No	-	-	-
Sanden No.	-	-	-
Mounting	-	-	-
Rotor	-	-	-
GL	-	-	-
Armature	-	-	-
Diameter	-	-	-
Voltage	-	-	-
Orientation	-	-	-
Fitting	-	-	-

DELPHI	-	SP15	-
Comp No	-	0310.0021	-
Sanden No.	-	015203/1	-
Mounting	-	Ear	-
Rotor	-	8PV	-
GL	-	50.1	-
Armature	-	SL	-
Diameter	-	122.4	-
Voltage	-	12	-
Orientation	-	H	-
Fitting	-	1-14 UNF-2A	-

**STANDARD FASTENER TORQUE VALUES**

In the absence of specific torque values detailed in this fitting instruction manual, the following chart can be used as a guide to the maximum safe torque for specific size and grade of fastener.

**COUPLES DE SERRAGE DES FIXATIONS STANDARDS**

Si des chiffres de serrage au couple particuliers ne sont pas indiqués dans cette notice de montage, se référer au tableau suivant qui servira de guide pour le couple de sécurité maximum correspondant à une taille et un grade spécifiques de fixation.

**ANZIEHMOMENTE FÜR STANDARDBEFESTIGUNGSMITTEL**





Falls in dieser Einbauanleitung keine speziellen Anziehmomente angegeben sind, kann die folgende Tabelle als Richtlinie für das maximale sichere Anziehmoment für eine spezifische Größe oder Qualität von Befestigungsmitteln dienen.

**VALORI STANDARD DI SERRAGGIO PER DISPOSITIVI DI FISSAGGIO**

In assenza di valori specifici di coppia nel presente manuale di istruzioni, si può utilizzare la seguente tabella come guida per conoscere la coppia massima sicura in base a dimensioni e grado del dispositivo di fissaggio.

**VALORES ESTÁNDAR DE LOS PARES DE APRIETE Y FIJACIÓN**

En ausencia de valores para los pares de apriete específicos detallados en este manual de instrucciones de montaje, se puede utilizar la siguiente tabla como guía para consultar el máximo par de torsión seguro para un tamaño concreto y su grado de fijación.

STRENGTH								
	Max Torque		Max Torque		Max Torque		Max Torque	
Dia / Pitch	lb.ft	Nm	lb.ft	Nm	lb.ft	Nm	lb.ft	Nm
M5 x 0.80	2	3	4.5	6	6.5	9	7.5	10
M6 x 1.00	4	5.5	7.5	10	11	15	13	18
M8 x 1.25	10	13	18	25	26	35	33	45
M10 x 1.25	20	27	39	53	57	78	66	90
M10 x 1.50	18	25	37	50	55	73	63	86
M12 x 1.75	33	45	63	85	97	130	111	150
M14 x 2.00	55	75	103	140	151	205	177	240
M16 x 2.00	85	115	159	215	232	315	273	370

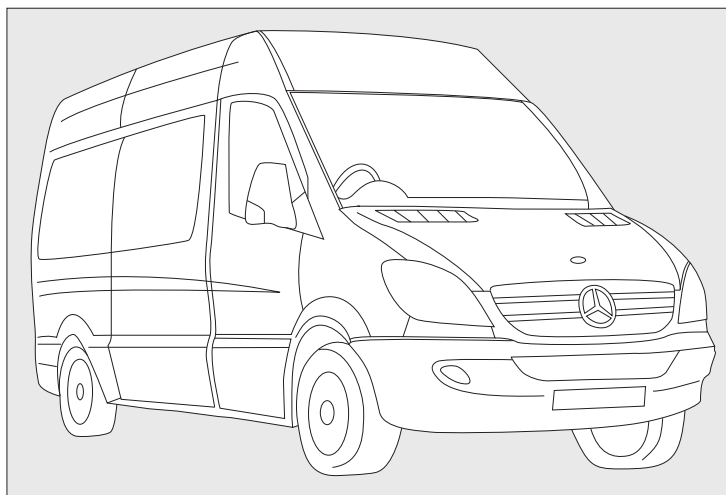

## VEHICLE DETAILS

Manufacturer	Mercedes
Make	Sprinter
Model	2500 / 3500 / 219 / 319 / 419 / 519
Engine CC	2987 cc
Engine Details	OM 642 V6 Cdi Euro 5 / EEV / Euro 6
Year	08.2009>
Chassis Nos.	N/A
LHD	YES
RHD	YES
PAS	YES
A/C	YES / NO
Voltage	12v

## KIT DETAILS

Kit Part Number	0500.6952
Description	Standard Kit
Compressor RPM	4695 @ Max engine power output
Fitting Time	30 Minutes
Suction Fitting	90°
Discharge Fitting	90°
Belt Type	6PK 1438
Belt Part Number	0820.7271
Note:	-N63/-LBS Option

## FOREWORD

The purpose of this manual is to facilitate the installation of a direct drive compressor. The information given is merely instructive, should any complications arise contact the Technical department. The manufacturer's warranty does not cover any problems caused by defective installation or alterations made unless authorised. The manufacturer shall not be responsible for any injury, damage or loss caused directly or indirectly as a result of using this manual or the information contained within it.

### 1 SAFETY MEASURES:

**Before fitting the Compressor adapter drive kit, ensure the following for damage:**

- a Inner and outer trim and body work
- b Engine idle pace
- c Check all the vehicle functions

**Check list:**

- a Ensure that the right kit has been selected
- b Before installing, check that all the correct pieces are present; also ensure that there are no missing or broken pieces
- c When fitting, make sure the vehicle is properly protected against damage.

### Installation apparatus

- a Calibrated torque wrench
- b Hand service tools
- c Protective covers and shields

### 2 PRECAUTIONS

- a Detach the battery negative lead.
- b Torque all bolts where stated using a calibrated torque wrench.
- c Take extreme care with moving parts.
- d Remove the vehicle's ignition key and keep it with you.
- e Wear safeguards and make sure that liquid refrigerant never touches your skin

**Caution:** Measures must be followed accurately to steer clear of the possibility of damage to individuals

**Warning:** This calls awareness to actions which must be pursued to avoid damage to the components.

**NB:** This calls awareness to make the job easier or gives useful information.

## PRE-INSTALLATION

**Note:** Before proceeding please read the installation precautions. The letters on drawings relate to text, numbers circled relate to the parts list in this manual.

## INSTALLATION

### Euro 5 / 6 Vehicles Only

1. Remove and retain bolt (A) securing the fan support tube - Fig 1
2. Disconnect the wiring plug (B) from the fan assembly - Fig 1

### All Vehicles

3. Remove and discard the original stretch belt (C) - Fig 1

**Note:** It is not necessary to remove the viscous fan to install this mount kit.

## MOUNT BRACKET INSTALLATION

1. Assemble the idle pulley (6) to the mount bracket (1) - Fig 2

**Note:** The idle pulley securing bolt is designed to fit into the pulley from one direction only. The metal bearing shield on the rear of the bearing should face the mount bracket (1)

2. Torque the idle pulley (6) to 25 Nm / 18 lb-ft using a calibrated torque wrench - Fig 2

3. Install the mount bracket (1) to the engine at fixing points (D) in the position below the alternator using the supplied M8x60 bolts (4) - Fig 3 / 4

4. Torque bolts (4) to 30 Nm / 22 lb-ft using a calibrated torque wrench - Fig 4

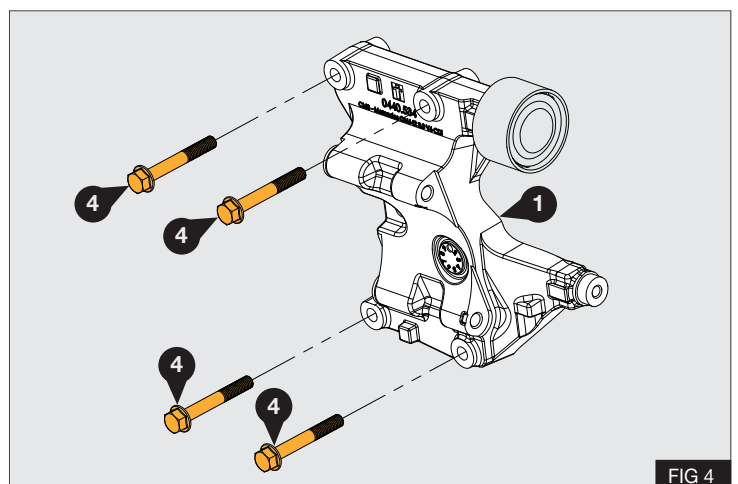
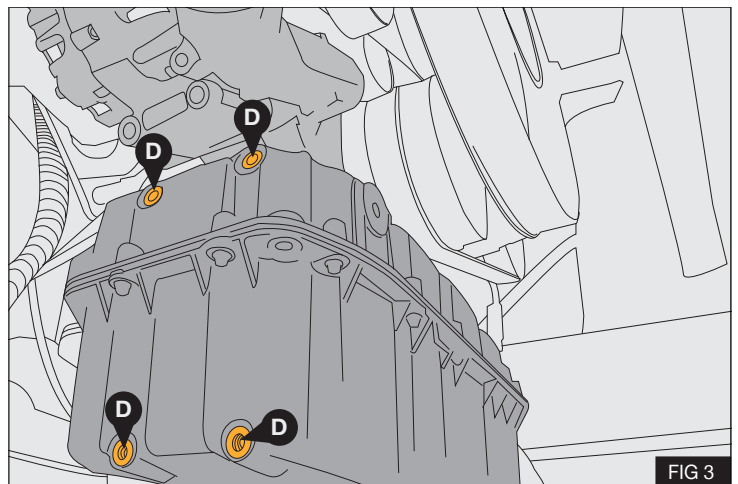
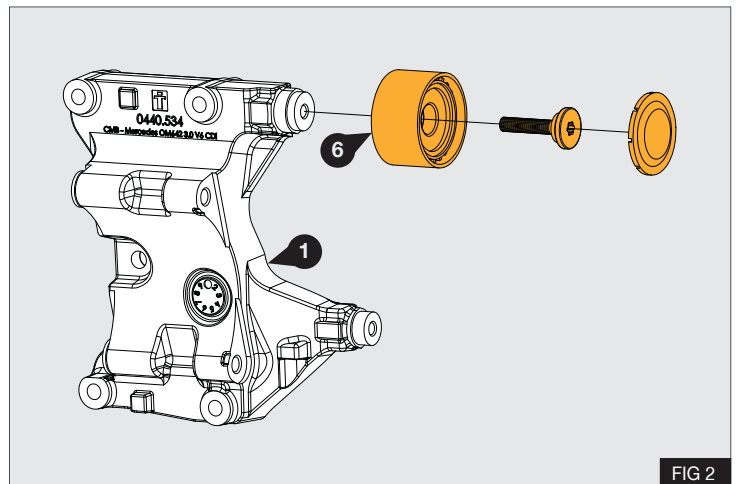
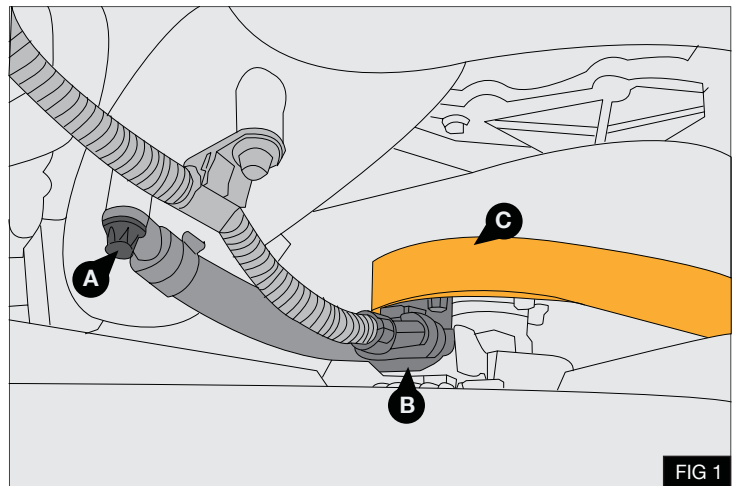



5. Secure the Automatic tensioner (7) to the original hole (E) as detailed in Fig 3, on the sump using bolt (3). Secure the Automatic tensioner (7) to the mount bracket (1) using bolt (5) - Fig 5

Torque M8x65 bolt (5) to 27.5 +/- 2. 2 Nm or 20.3 +/-1.6 lb-ft using a calibrated torque wrench - Fig 5

Torque M8x35 bolt (5) to 30 Nm / 22 lb-ft using a calibrated torque wrench - Fig 5

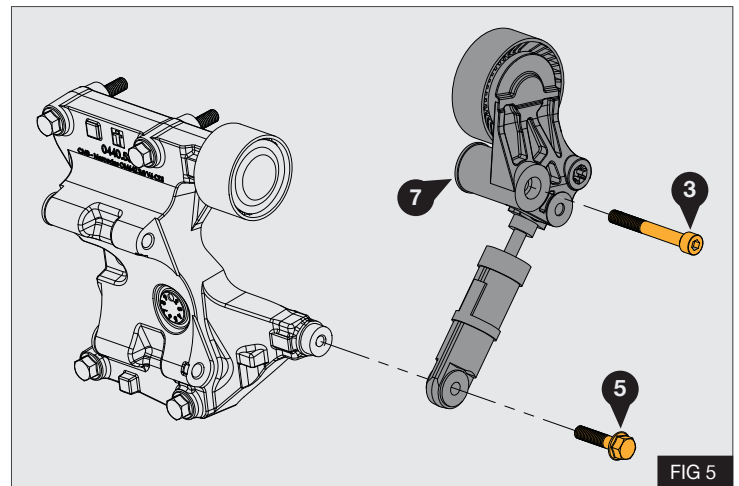

6. Install the compressor to the mount bracket (1) using the 4x supplied bolts (2) - Fig 6

**Important:** Follow the tighten procedure below for bolts (2)

7. Torque the 2x front bolts (2) to 63 Nm / 46 lb-ft
8. Tighten the 2x rear bolts (2) until the sliding bushes in bracket (1) contact the rear compressor ears. Then torque the 2x rear bolts (2) to 63 Nm / 46 lb-ft

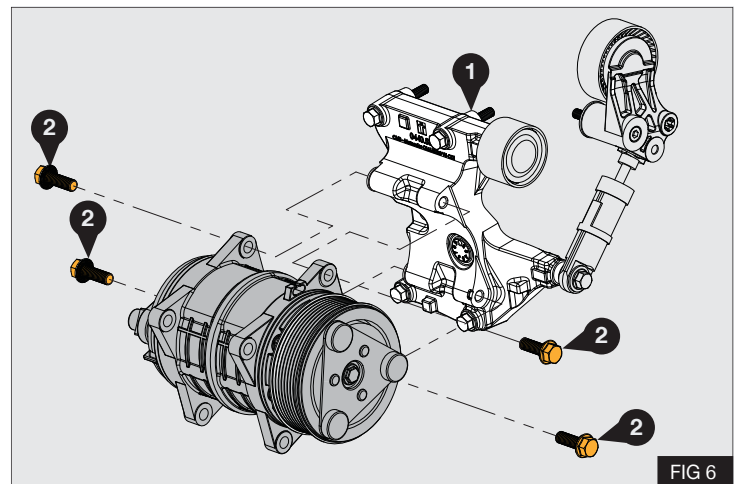

9. Before installing the drive belt (8) cycle the tensioner assembly (7) through its full travel a minimum of three times - Fig 7

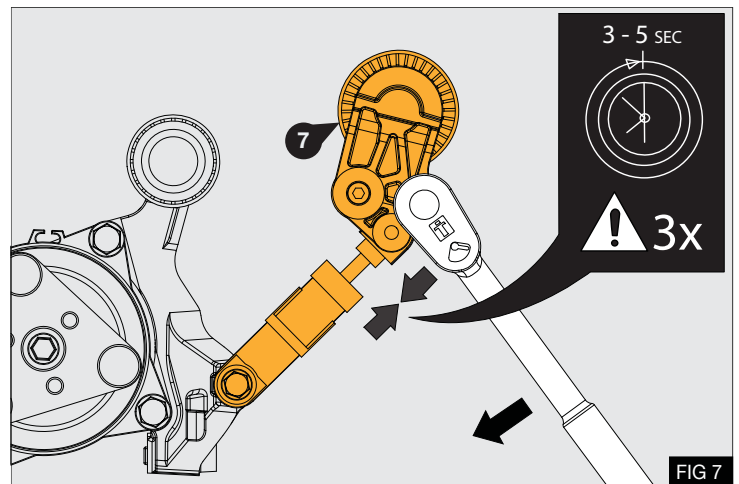

## DRIVE BELT INSTALLATION

1. Feed the supplied drive belt (8) over the viscous fan and to the pulleys as shown opposite - Fig 8

- A Crankshaft Pulley
- B Tensioner Pulley
- C Compressor
- D Idle Pulley
- E Fan Pulley

**Note:** Fit Drive belt (8) over idle pulley (D) last

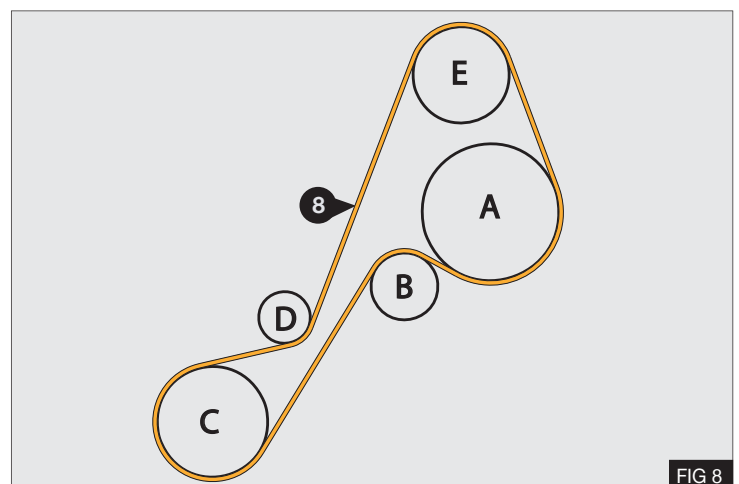

1. Place the belt in the correct groove of the compressor :
2. Valeo / QUE / Sanden<sup>(1)</sup> compressors - Belt is installed in the grooves at the front of the compressor pulley - Fig 9

<sup>(1)</sup>Model Specific

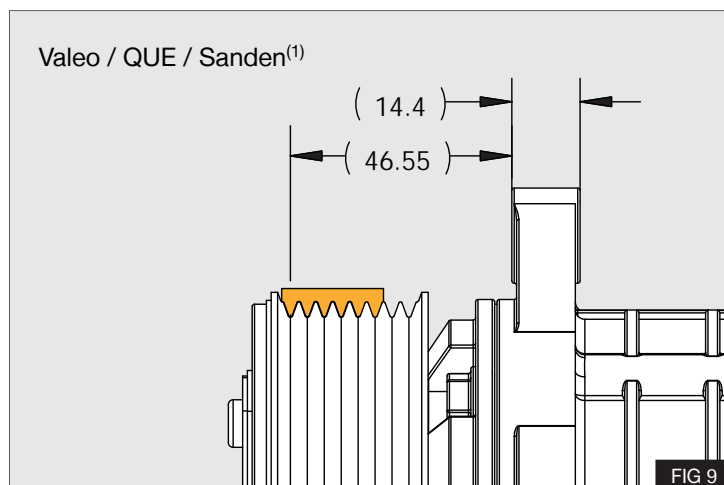

3. Delphi / Sanden<sup>(1)</sup> compressors - Belt is installed with one spare groove at the front of the compressor pulley - Fig 10

<sup>(1)</sup>Model Specific

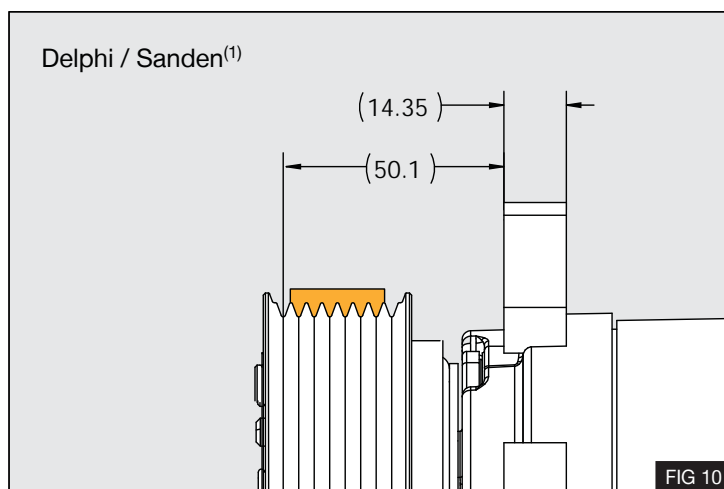

## FINISH

### Euro 5 / 6 vehicles only

1. Refit the bolt (A) securing the fan support tube. Reconnect the wiring plug (B) to the fan assembly - Fig 1

### All Vehicles

2. Run the engine with the compressor clutch engaged for five minutes, Check all components
3. Install the supplied belt label in the engine bay



(EN)

Techni focuses on constant upgrading of its products. The Manufacturer reserves the right to modify the models and components described in the present publication at any time for technical or commercial reasons and without prior notice. For further information, contact Techni technical services.

(DE)

Techni ist stets bestrebt die eigenen Produkte zu verbessern. Die Herstellerfirma behält sich das Recht vor, aus technischen oder Verkaufsgründen, zu jeder Zeit und ohne vorherige Ankündigung, Abänderungen an den Modellen und den in dieser Veröffentlichung beschriebenen Einbauteile vorzunehmen. Für weitere Informationen bitten wir Sie, sich an unseren Techni Kundendienst zu wenden.

(FR)

Techni vise à une amélioration constante des ces produits. La maison se réserve le droit d'apporter, à tout moment et sans préavis, des modifications aux modèles et aux composants décrits dans cette publication pour des raisons d'ordre technique ou commerciale. Pour d'ultérieures informations s'adresser au service d'assistance Techni.

(IT)

Techni mira ad un costante miglioramento dei propri prodotti. La Casa si riserva il diritto di apportare in qualunque momento e senza preavviso modifiche ai modelli e ai componenti descritti in questa pubblicazione per ragioni di natura tecnica o commerciale. Per ulteriori informazioni rivolgersi al servizio assistenza Techni.

(ES)

Techni aspira a un constante mejoramiento de su producción. La Fábrica se reserva el derecho de aportar en cualquier momento y sin preaviso modificaciones a los modelos y los componentes descritos en esta publicación por razones técnicas o comerciales. Para ulteriores informaciones dirigirse al servicio asistencia Techni.

VENDITA E SERVIZIO  
VENTE ET SERVICE

SALES AND SERVICE  
VERKAUF UND SERVICE



Sundorne Trade Park, Henley Way,  
Shrewsbury, United Kingdom, SY1 4NS  
Telephone (+44) (0) 1743 443176  
Fax (+44) (0) 1743 443113  
Email: [sales@techni.co.uk](mailto:sales@techni.co.uk)